

# **Stage 1** H/DUTY BALL RACE THRUST BEARINGS & Elastomer Centers **(STREET)**

## **STREET** CAMBER & CASTER Adjustment For The 1st. Time

Also MANF. **STAGE 2** (STREET/RACE) and **STAGE 3** (FULL RACE) KITS  
Plus front (Track days) extra Camber & Caster performance bushings  
(Lower control arm and thrust arms inner also improving brake & steering response) For the Rear - Camber & Toe adjuster kit. (#193326)

✓ Can fit (and) adjust with strut brace fitted

Kits designed to simply replace  
original strut 'upper' mounts, no mods  
(All items above Coil spring except for OEM dust cover)

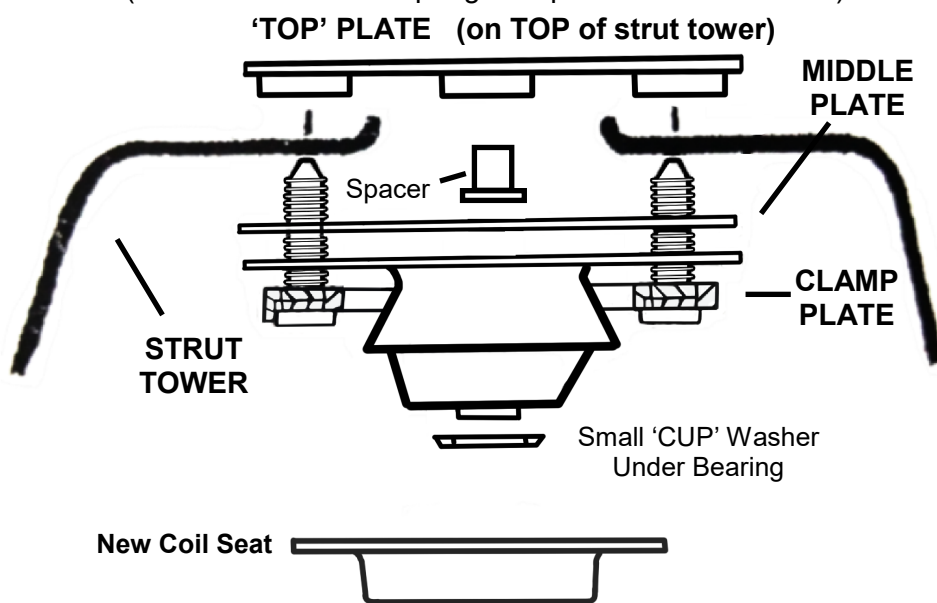

Refer manufacturers workshop manual re removal and installation  
Observe all safety procedures

**A. IF OUTER TIRE WEAR OR  
(RACE/COMPETITION) MOUNT  
POSITION NEGATIVE (-) CAMBER**

And to REAR for Pos. Caster.

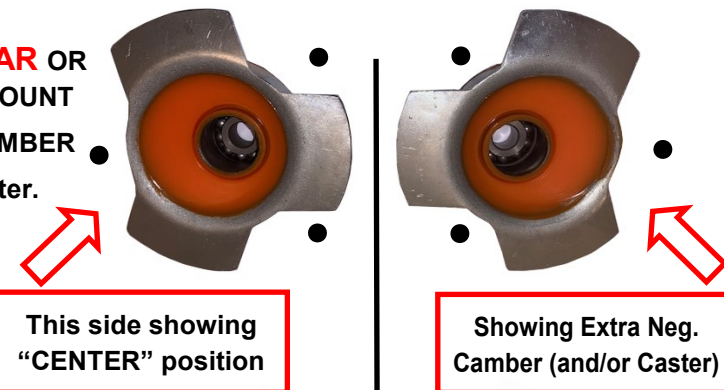

**B. IF INNER TIRE WEAR  
MOUNT POSITION POSITIVE  
(+) CAMBER**

And to REAR for Pos. Caster.

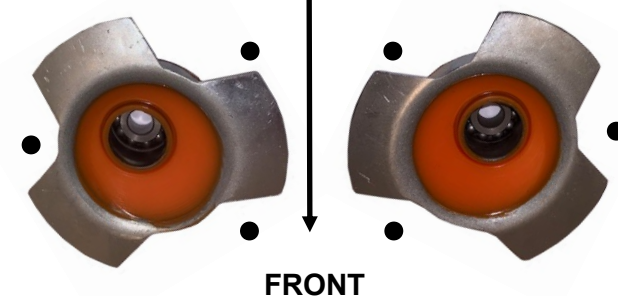

**ALIGNING** KMAC Patented design allows adjustment to be carried  
out accurately (under load). No need to jack vehicle.

- From engine bay, loosen the '3' top nuts for strut tower upper mount.
- Use large screwdriver to lever / ratchet KMAC adjuster mount crossways for CAMBER, then lengthways for required CASTER.
- Once optimum settings, tighten the 'TOP' KMAC NUTS - HAND WRENCH TORQUE TO **27Nm (20ft/lbs)** - NOT IMPAC GUN



**FRONT #193416-1J STAGE 1 (STREET)**

**BMW E34 '5', E32 '7'**

**FRONT CAMBER (and CASTER) FOR THE 1st TIME**  
(and accurate-underload direct on alignment rack)

- ✓ **Quickest Adjustment** - Change Camber & Caster settings - from engine bay and with strut brace fitted
- ✓ **Centers H/Duty** - Ball Race (Thrust Bearings for steering loads with elastomer for extended wear life)

**ALSO MANUFACTURED**  
**STAGE 2 (STREET / RACE), STAGE 3 (FULL RACE).**  
SEE WEB SITE

- **FRONT** - Also extra Camber and Caster (Track days) - Lower arm inner bushes (Camber) and thrust arm for Caster. Both single wrench precisely adjustable.

***Always 1st With The Latest Design Breakthroughs ....***

- 1. WISHBONE:** Precise Ball Joint Adjustment System.
  - 2. STRUT(top):** Biggest/Quickest Adjustment System.
  - 3. BUSHINGS:** Single Wrench - Precise On Car Adjustment.
- Including unique KMAC "non-slip" lock system!**  
***Actual Inventors/Patentee's - The '3' Basic Suspension Systems***

*We do appreciate any ideas to further improve our market leadership !*